

Access control

TESA

ASSA ABLOY



Access control for each and everyone



TESA is launching its new access control, which employs neither software nor management systems. Its product range is simple, wireless and completely autonomous.

A customized solution

TESA is launching its new access control, which employs neither software nor management systems. Its product range is simple, wireless and completely autonomous.



Total compatibility

100% compatible with TESA's electromechanical products, and 100% compatible with TESA's armoured doors in order to ensure active and passive security and safety.



We can grant access to everything

From a gate with a TITANIUM security padlock to a glass door with a knob from the ACCESS range. Plus metallic doors, fire doors, etc.



Simplicity above all

As long as you have a programming key/card and user credentials, you can start the system. In a few minutes you will have an access control installed in your door.

NO SOFTWARE, NO MANAGEMENT EQUIPMENT



CD



PC



EDITOR



PP

Guaranteed by TESA

Purchasing TESA is synonym of quality. Top-notch technology, expertise and certified processes awarded by the ISO 9001 and 14001 quality standards confirm the path to continuous innovation, growth and expansion within the organization.



Visual index



Proximity technology card
Page 5



Proximity technology key
Page 12



Electronic key
Page 13



Pin code
Page 17

Stand alone access control

Proximity technology card

Electronic lock

- » Slim design that allows the installation in every door type.
- » Wide range of lever designs and mortise locks.
- » Two different aesthetics: long plate or rose handle + independent reader.
- » No wirings. Standard battery-powered lock.
- » Nor software, neither management devices needed.
- » Unlimited nr. of doors, up to 500 different users per door.
- » Identity technology: 13,56 MHz MIFARE standard.
- » Finishes: Stainless steel (I), PVD satin brass (PVDM), PVD polished brass (PVDD).
- » Distance between axes: 70, 72, 85, 92 or 105 mm.
- » Square spindle 8 mm.
- » All the control components (excepting the reader module) are placed in the inside escutcheon, therefore offering anti-vandalism protection.
- » Emergency key override optional.

NO SOFTWARE, NO MANAGEMENT EQUIPMENT

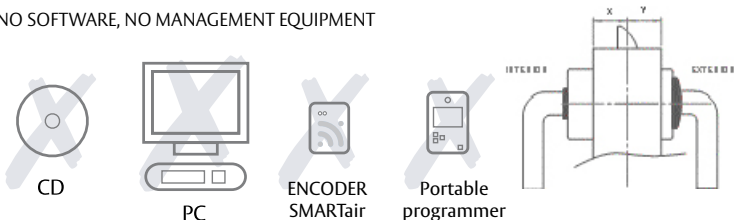

To order specify X and Y distances (see picture).

- » The lock includes one user keycard. Programming and user cards, mechanical cylinder and mortise lock to be ordered separately.
- » Mortise locks with standard follower. Split follower can not be used.



Stand alone access control

Proximity technology card

Models

Long plate



Long plate

Long plate with cylinder

Long plate with concealed cylinder

Short plate



Short plate

Short plate with cylinder

Functions

Models with electronic privacy: (the internal side is always the same in both the long plate and short plate models).

Models without electronic privacy: (the internal side is always the same in both the long plate and short plate models).



Internal thumb - turn



Neither cylinder nor thumb - turn



External cylinder /Internal cylinder

Handles



Vector



Sena



Xara



Zafira



Pull knob

Stand alone access control

Proximity technology card

No cylinder, no thumbturn

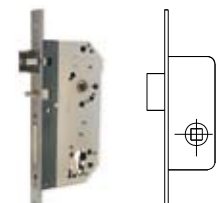
	Product code	Description
	STAC12SL1S008VI	Standalone lock for inside doors, long plate, visible cylinder, vector handle, stainless steel
	STAC12XL1S008VI	Standalone lock for external doors, long plate, visible cylinder, vector handle, stainless steel
	STAC12SC1S008VI	Standalone lock for inside doors, short plate, visible cylinder, vector handle, stainless steel
	STAC12XC1S008VI	Standalone lock for external doors, short plate, visible cylinder, vector handle, stainless steel
	2UB4FA60AI	Wooden doors. Panic function.
	221528AI	Metalic doors. No panic function.

Recommended mortise locks (not included).

*Cylinder not included. Take into account 15 mm outside and 25 mm inside.
Example: for a lock centered in a 40 mm thickness door, select the 35-45 mm cylinder.

No external cylinder, internal thumbturn

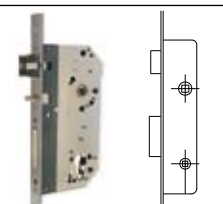
	Product code	Description
	STAC12SL5S858VI	Standalone lock for inside doors, long plate, internal thumbturn, vector handle, stainless steel
	STAC12XL5S858VI	Standalone lock for external doors, long plate, internal thumbturn, vector handle, stainless steel
	STAC12SC5S858VI	Standalone lock for inside doors, short plate, internal thumbturn, vector handle, stainless steel
	STAC12XC5S858VI	Standalone lock for external doors, short plate, internal thumbturn, vector handle, stainless steel
	2UB4FA60AI	Wooden doors. Panic function.
	221428AI	Metalic doors. No panic function.

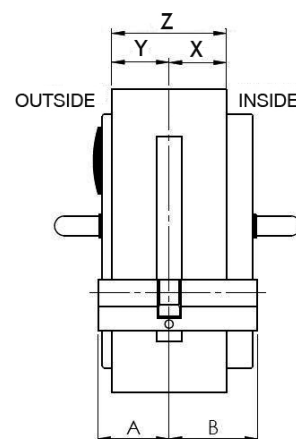

Recommended mortise locks (not included).



Stand alone access control

Proximity technology card

Double cylinder

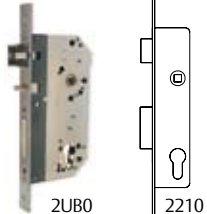
	Product code	Description
	STAC12SL3V858VI	Standalone lock for inside doors, long plate, visible cylinder, vector handle, stainless steel
	STAC12XL3V858VI	Standalone lock for external doors, long plate, visible cylinder, vector handle, stainless steel
	STAC12SC3V858VI	Standalone lock for inside doors, short plate, visible cylinder, vector handle, stainless steel
	STAC12XC3V858VI	Standalone lock for external doors, short plate, visible cylinder, vector handle, stainless steel
	2UB0FA60AI	Wooden doors. Panic function.
	221028AI	Metalic doors. No panic function.

Recommended mortise locks
(not included)

Exhibitors

	Product code	Description
	STAC12SL1SDEMO	Lock without cylinder
	STAC12SL5SDEMO	Lock with internal thumbturn
	STAC12SL3VDEMO	Lock with double visible cylinder.

Spindle kits

Product code	Description
STCCSPINKIT3038	Spindle KIT 30 / 38
STCCSPINKIT3844	Spindle KIT 38 / 44
STCCSPINKIT4450	Spindle KIT 44 / 50
STCCSPINKIT5056	Spindle KIT 50 / 56

Product code	Description
STCCSPINKIT5662	Spindle KIT 56 / 62
STCCSPINKIT6268	Spindle KIT 62 / 68
STCCSPINKIT6874	Spindle KIT 68 / 74
STCCSPINKIT0410	Spindle KIT 104 / 110

* De acuerdo al espesor (z) de la puerta

Stand alone access control

Proximity technology card

Electronic Knob Cylinder

- » Allows the installation in every door type. Ideal for RETROFIT operations which require keeping part of the installation.
- » Compatible with mortise locks that allow cylinder installation.
- » Models: Half cylinder, double cylinder with mechanical inside knob and double cylinder with inside electronic knob control.
- » Stand-alone operation. No wirings. Standard battery-powered lock.
- » No software, no management equipment
- » Unlimited nr. of doors, up to 500 different users per door.
- » Identity technology: 13,56 MHz MIFARE standard.
- » Emergency power device
- » Finishes: Standard stainless steel
- » No wirings. Standard battery-powered lock.
- » All the control components (excepting the reader module) are placed in the inside
- » When the cylinder is in closed mode. The knob turns freely avoiding the possibility of being forced.
- » Emergency key override optional.

NO SOFTWARE, NO MANAGEMENT EQUIPMENT

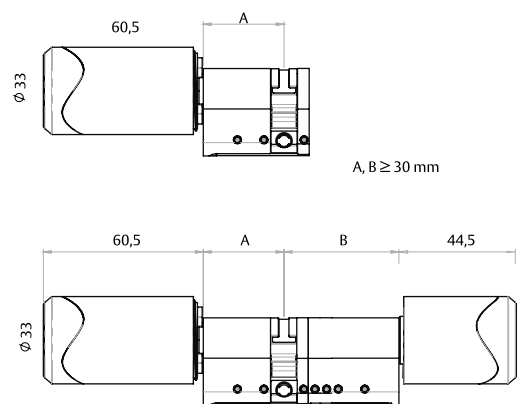
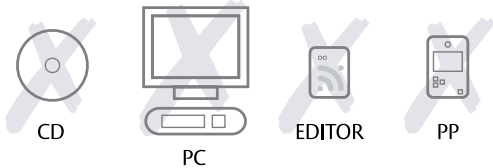

- » Various dimensions available for different door widths. Specify A and B distances (see picture)
- » The lock includes one user keycard. Programming card and mortise lockto be ordered separately.

Stand alone access control

Proximity technology card

Autoprogrammable wall reader

The reader activates the locking element with a relay: electric strike, electromagnetic/motorized lock, etc. 12Vac/Vdc external power supply required.

Connectors	Description
CN1	12Vac/Vdc power supply
CN2	Standby consumption 80 uA Consumption with operating relay: 150 mA
CN3	Relay backset: NO, NC and C. Cut capacity: 5A 250Vac/5A 30Vdc
CLR	RESET button for the erasing of the reader's memory

Operation conditions	Description
Humidity	Up to 85% without condensations
Temperature	-10° - 80°C



Noises of the electric strike: we recommend installing the VARISTOR (which is included in the package) in the electric strike in order to absorb the noises it may produce. ALTERNATING CURRENT ONLY

Mounting diagram

Delivered in a 1/1 box with screws, varistor, power supply and installation templates.

Once connected, and up to the moment when it has been programmed with the programming keycard, the reader is in.

Reference	Description
STAR2DSSI	lector mural autoprogramable design

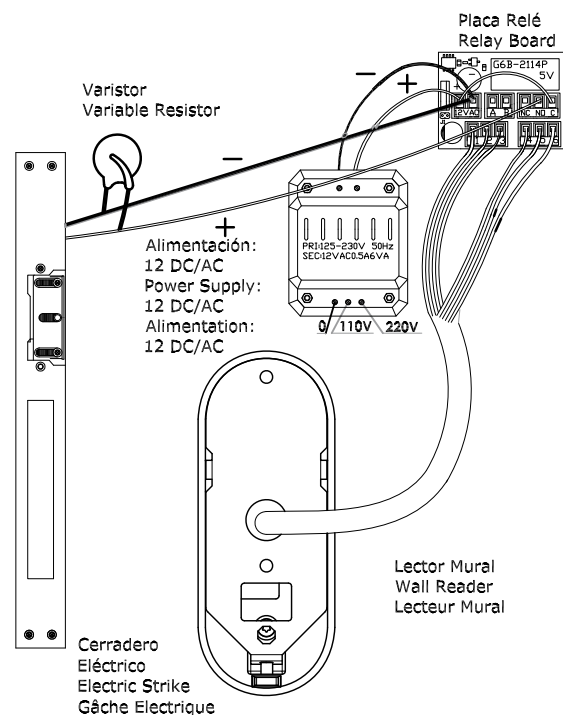

Stand alone access control

Proximity technology card

Autoprog. management kit

In order to start using an autoprogrammable SmartAir access control we require neither costly computer systems nor learning to use complex managements programs. All we need is a Programming card (which identifies an installation, making it different from the rest) and as many cards as users are required by the installation.

TESA has brought together all these elements in a kit, along with a simple tool that performs emergency openings when the system runs out of batteries.



Product code	Description
STACKITSTASDW	Stand-alone kit: includes programming card, 24 key cards (12 users, 12 shadow cards) and emergency opening battery.

Programming card

Its unique, exclusive code will allow to program as many locks as is required by the installation. You can rest assured that no other programming card will be taken into account from that moment on.

The programming card with Shadow function allows to:

- » Add users and their shadow cards.
- » Add users with option to leave the door in passage mode and their shadow cards.
- » Lost card cancellation in the lock through the shadow card
- » Cancel all the users at a time.

Product code	Description
STACKICSTASDW	Programming keycard with shadow function



User cards

Ready to be included in the list of users allowed by each door, they will have to be presented to the lock before they've been allowed access.

Product code	Description
STATARS2T	Mifare 1K user keycard

Simple functionality

By installing three AAA batteries in this element, and once it has been connected to the lock, we will be able to replace the internal batteries in case the system runs out of them. Once it's been connected, the door will allow access to any authorized card.

Product code	Description
STACKITEMERG	Emergency opening battery



Stand alone access control

Proximity technology card

Program standard users

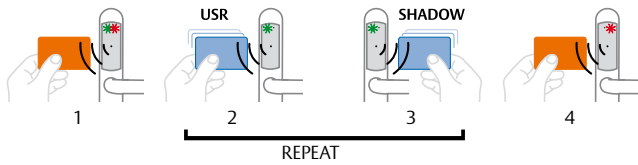

1. Open programming mode with programming card.
- 2-3. Present 2 user cards one followed by the other (green light will flash faster) the second card will be the shadow card of the first one.
4. Close programming mode (it is also automatically closed after 10 seconds).
Note: If only one user card is presented, the user will not be programmed and it will not have access.

Program passage functionality user

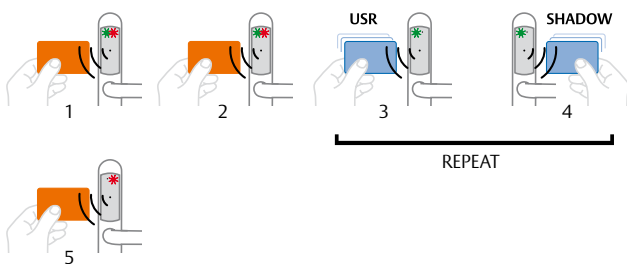

- 1-2. Open Passage Functionality programming mode placing two times the programming card (lights will flash faster on second approach).
- 3-4. Present two user cards one followed by the other (green light will flash faster) the second card will be the shadow card of the first one.
5. Close programming mode (it is also automatically closed after 10 seconds).
Note: If only one user card presented, the user will not be programmed and it will not have access.

Start / stop passage mode

Start passage mode

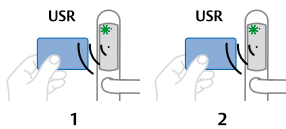

- 1-2. To leave an Smartair Standalone Escutcheon or wall reader in passage mode place two times a Passage Functionality User card (green light will flash).

- 3-4. To finish the passage mode place again two times a Passage Functionality user cards (green light flashing + constant red light).

Delete one user

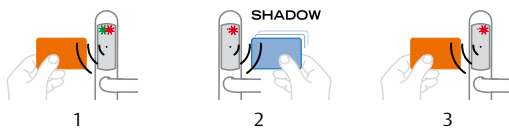

1. Open programming mode with programming card.
2. Present the shadow card of the user that wants to be deleted.
3. Close programming mode (it is also closed automatically after 10 seconds).

Cancel all cards

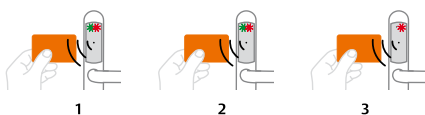

- 1-2-3. Place 3 times the programming card.

Opening with low batteries (only escutcheon)

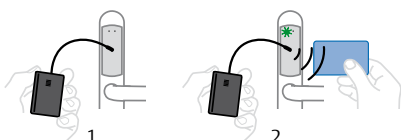

Escutcheon flashes red & green lights approaching a card when batteries are low.

1. Connect the emergency power supply kit.
2. Place a valid user card to open the door and change the batteries of the escutcheon.

Stand alone access control

Proximity technology key

Combi key RFID

The RFID COMBI key from TESA allows mechanical master key systems to be compatible with TESA Standalone or other access control systems in only one device or credential.

COMBI key can be compatible with mechanical T80, TX80 or TK100 cylinders, furthermore, user will also have access to RFID MIFARE technology electronic lock or wall readers simply approaching the key head.

Key head with RFID
MIFARE 1K technology chip
(European Standard)

mifare®



	Master keyed	Blank key
System	Product code	Product code
T80	LLAT80TALLCOMBI	LLAVBRT80COMBI
TX80	LLATX8TALLCOMBI	
TK100	LLATK1TALLCOMBI	

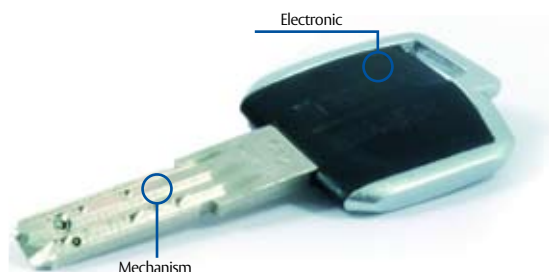

J

Stand alone access control

Electronic key

Stand alone electronic cylinder

- » Quick installation, just as a mechanical cylinder.
- » The cylinder has no power supply. The key supplies the energy required in order to open,
- » Autoprogrammable system – you just need a programming key and user's keys.
- » All the monitoring elements are located inside the cylinder, and therefore protected: control unit, reader and deadbolt device.
- » In the outdoors version, the electronic cylinder is resistant to water and to adverse climatic conditions.
- » It is possible to have a stock of replacement cylinders that can be easily recorded and integrated with the installation.
- » It is possible to combine in one installation TESA's mechanical and electronic cylinders.



Types of cylinders

All the necessary elements (control unit, reader and motorized clutch) are located in one side of the cylinder, with a minimum length of 35mm.

	Version
Standard	For internal doors
Outdoors	Water resistance
	All the electronic elements have been silicon-coated and protected with sealing joints. IP54 degree of protection from humidity and condensation.
	Lengths
Minimum	Half cylinder 35x10 mm. Double cylinder 35 x 35 mm.
Supplements	5mm intervals in any side with a maximum total (for both sides) of 120 mm or 75 mm on one side. Ask for other sizes.
	Excentric
13,2 mm	Ironwork doors with eccentric lock 13,2
15 mm	Other doors
	Finishes
	Nickel
	Polished brass PVD



Half cylinder



Electronic - Electronic



Electronic - Thumbturn



Electronic - Mechanical

Stand alone access control

Electronic key

Electronic key

- » Non-volatile memory of the key. No information will be lost when the battery is used up or replaced.
- » Protected data prevent the key from duplication.
- » One only red authorization key for each installation ensures that only the person in charge of the key will be able to record keys and cylinders.
- » Reading and writing contact chip.
- » Great capacity for storing and protecting data.
- » Encrypted data transmission between the cylinder and the key.



Operation conditions

Humidity	Temperature
Up to 85% without condensation	-20°C / 70°C

NON SOFTWARE, NO MANAGEMENT EQUIPMENT

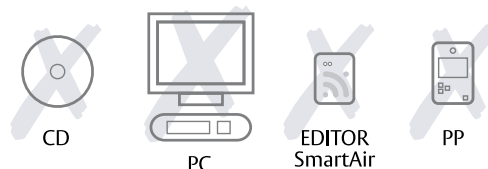

Types of key

Options	
Electronic Key	(Uncarved) for installations with electronic cylinders
T80 carved key	To be combined with mechanical cylinders (T80 system)
TX80 carved key	To be combined with mechanical cylinders (TX80 system)

Technical Features	
Size	95 x 36 x 9 mm
Technology	Contact chip
Power supply	Type of battery: CR 2032 Li-Mn 3V Estimated duration: > 10,000 operations
Warning LED	Green LED: authorized access.
	Red LED: denied access.
	Flashing LED: low battery warning



Stand alone access control

Electronic key

Type	Use	Cam	Electronic side	Mechanic side	Finish	Product code
Half electronic cylinder(STAX)	Standard (S)	15mm (5)	35E	10M	Nickel (N)	STAXSE535E10MN
Half electronic cylinder(STAX)	Standard (S)	15mm (5)	40E	10M	Nickel (N)	STAXSE540E10MN
Half electronic cylinder(STAX)	Standard (S)	15mm (5)	45E	10M	Nickel (N)	STAXSE545E10MN
Half electronic cylinder(STAX)	All weather (X)	13,2 mm (3)	50E	10M	Polished brass (D)	STAXSE350E10MD
Half electronic cylinder(STAX)	All weather (X)	13,2 mm (3)	55E	10M	Polished brass (D)	STAXSE355E10MD
Half electronic cylinder(STAX)	All weather (X)	13,2 mm (3)	60E	10M	Polished brass (D)	STAXSE360E10MD

Type	Use	Cam	Electronic side	Mechanic side	Finish	Product code
Electrónico mechanical cylinder (STAX)	Standard (S)	15mm (5)	35E	35E	Nickel (N)	STAXSE535E35MN
Electrónico mechanical cylinder (STAX)	Standard (S)	15mm (5)	40E	40E	Nickel (N)	STAXSE540E40MN
Electrónico mechanical cylinder (STAX)	Standard (S)	15mm (5)	45E	45E	Nickel (N)	STAXSE545E45MN
Electrónico mechanical cylinder (STAX)	All weather (X)	13,2 mm (3)	50E	50M	Polished brass (D)	STAXSE350E50MD
Electrónico mechanical cylinder (STAX)	All weather (X)	13,2 mm (3)	55E	55M	Polished brass (D)	STAXSE355E55MD
Electrónico mechanical cylinder (STAX)	All weather (X)	13,2 mm (3)	60E	60M	Polished brass (D)	STAXSE360E60MD

Type	Use	Cam	Electronic side	Mechanic side	Finish	Product code
Electronic thumbturn (STAX)	Standard (S)	15mm (5)	35E	35B	Nickel (N)	STAXSE535E35BN
Electronic thumbturn (STAX)	Standard (S)	15mm (5)	40E	40B	Nickel (N)	STAXSE540E40BN
Electronic thumbturn (STAX)	Standard (S)	15mm (5)	45E	45B	Nickel (N)	STAXSE545E45BN
Electronic thumbturn (STAX)	All weather (X)	13,2 mm (3)	50E	50B	Polished brass (D)	STAXSE350E50BD
Electronic thumbturn (STAX)	All weather (X)	13,2 mm (3)	55E	55B	Polished brass (D)	STAXSE355E50BD
Electronic thumbturn (STAX)	All weather (X)	13,2 mm (3)	60E	60B	Polished brass (D)	STAXSE360E50BD

Type	Use	Cam	Electronic side	Mechanic side	Finish	Product code
Electronic - electronic (STAX)	Standard (S)	15mm (5)	35E	35B	Nickel (N)	STAXSE535E35EN
Electronic - electronic (STAX)	Standard (S)	15mm (5)	40E	40B	Nickel (N)	STAXSE540E40EN
Electronic - electronic (STAX)	Standard (S)	15mm (5)	45E	45B	Nickel (N)	STAXSE545E45EN
Electronic - electronic (STAX)	All weather (X)	13,2 mm (3)	50E	50B	Polished brass (D)	STAXSE350E50ED
Electronic - electronic (STAX)	All weather (X)	13,2 mm (3)	55E	55B	Polished brass (D)	STAXSE355E50ED
Electronic - electronic (STAX)	All weather (X)	13,2 mm (3)	60E	60B	Polished brass (D)	STAXSE360E50ED

- » No winings, no battery needed. The system works feeded through a standard battery in the key.
- » No software, no management station are needed.
- » Unlimited number of doors; up to 500 users per door.
- » Product range: e - cylinders, half e - cylinders, e - knobsets and e - padlocks.
- » Electronic keys can open as well masterkeyed mechanical cylinders T80 and TX80.

Programming key and autoprogrammable kit

Product code	Description
STAXKITSTA	Stand alone kit (programming key + 3 users keys)
STAXLICSTA	Programming key

NO SOFTWARE, NO MANAGEMENT EQUIPMENT

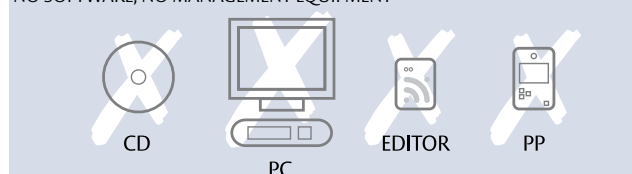

User keys

Type	Format	Compatible with	Product code
TS	Blank	T80	STALXCTSNNGNT
TS	Cut	T80	STALXCTSTGNT
SE	Cut (only in TESA)	TX80	STALXCSETGNT

Stand alone access control

Electronic key

Autoprogr. management kit

The autoprogrammable cylinder brings you all the advantages and flexibility of the access control offline cylinder while at the same time sidestepping the complications derived from the management devices they include.

The autoprogrammable management Kit includes: a (red) programming card and three (grey) user keys.



Users register

- 1) Start the programming sequence by inserting the (red) programming key in the cylinder. The key's light will shine in red and green colours several times.
- 2) Insert the key you wish to authorize. The key's light will shine in green, flashing several times.

Repeat steps 1 and 2 for each key you wish to register in the cylinder.

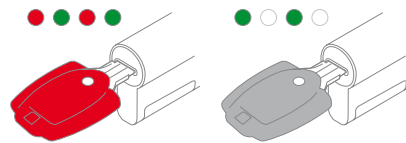

Delete users

- 1) Start the programming sequence by inserting the (red) programming key in the cylinder. The key's light will shine in red and green colours several times.
- 2) Insert the key you wish to delete. The key's light will shine in red, flashing several times.

Repeat steps 1 and 2 for each key you wish to delete from the cylinder.

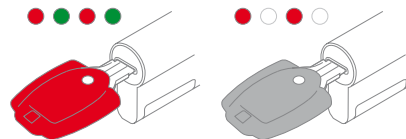

Erase all

- 1) Start the programming sequence by inserting the (red) programming key in the cylinder. The key's light will shine in red and green colours several times.
- 2) Insert for the second time the programming key. The key's light will shine in red, flashing quickly several times. The cylinder is warning us that total erasure is going to take place.
- 3) Insert for the third time the programming key. The key's light will shine in red permanently for a few seconds. The cylinder is now empty.

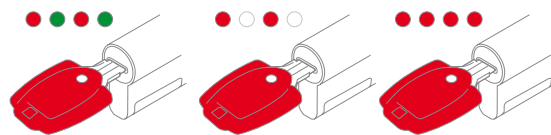

Stand alone access control

Pin code



Easy and convenient

CodeHandle is a set of handles with access control without any cards or keys, simple and effective. Its suitable for any kind of interior door, in residential or institutional environments where comfortable and ease of use its a priority. Code handle is the solution for most of the restricted areas: offices, warehouses, private areas, wardrobe, etc.

Attractive design and easy to install

As the keyboard is integrated in the handle is a more attractive option than the wall readers. Also is very easy to install: without cables, without special drills... you can install it as any other handle.

Technical features:

- » In doors: patented stand alone access control with code for internal door. A complete set is supplied including handles, rosettes, spindle, fixing through bolts and instructions. For 35 - 80 mm door thickness.
- » In windows, the handle is supplied with fixing screws and instructions.
- » Fits lock cases DIN standard. 8 mm spindle.
- » One master code and up to nine different user codes.
- » Auto locking function available.
- » Two CR2, 3V lithium batteries in the outer handle.
- » Visual and acoustic feedback.
- » Easy to fit, no cables.
- » Available for right- and left hand doors.
- » Only for indoor use.
- » Material: brushed stainless steel and satin chrome zink.



Function:

- » Four buttons to press a four- to six digit code to unlock and one button to lock.
- » Green light flashes and a sound is heard when the buttons are pressed for unlocking.
- » Red light flashes and a sound is heard when locking.
- » Master code and user code is programmed at installation. Can be changed unlimitedly.
- » If wrong code is pressed five times the handle is blocked for three minutes.
- » Free swing from the outside when locked, always possible to open with the handle from the inside.
- » The two batteries gives approximately 100.000 operations.
- » Red light indicates low battery when approximately 500 operations left

Standards

CE according to:

EMC Standards:: EN 61000-6-1, EN 61000-6-3, EN 61000-4-2, EN 61000-4-3, EN61000-4-8

Fire resistance standards: EN 1634-1:2008 y EN 1363-1:1999

Stand alone access control

Pin code

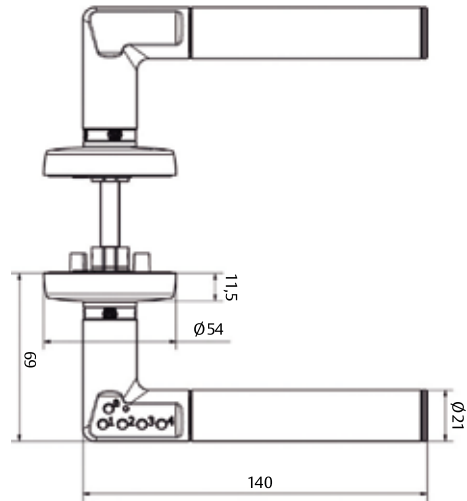

Locks for wooden doors

134U5RAI – Latch lock with 50 mm backset with half cylinder 30 x 10 mm.

203050AI – Latch lock with 50 mm backset.



134U5RAI

Handle for door	Product code	Finish	Hand
	MCHIR800	CM	Left
	MCHDR800	CM	Right

Handle for window	Product code	Finish	Hand
	MVCHIR800	CM	Left
	MVCHDR800	CM	Right

IMPORTANT

To make the emergency opening easier we recommend to install TESA Code-handle with a mortise lock with cylinder.

Hands of the doors from the Codehandle side (exterior):

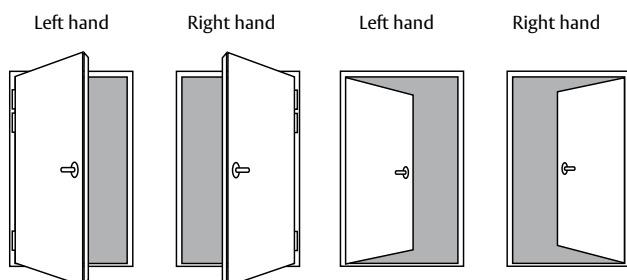

Stand alone access control

Pin code

Teclado autónomo

Teclado antivandálico capaz de gestionar un Control de Accesos de hasta 500 usuarios con códigos numéricos de 4 dígitos.

Funcionamiento

» Gestión de códigos numéricos de 4 dígitos para un máximo de 500 usuarios.

Características mecánicas

- » Carcasa antivandálica de Zamak con acabado INOX
- » Protección contra la intemperie mediante junta de goma sellante (P65)
- » Dimensiones: 120 x 76 x 21 mm
- » Peso: 410g.
- » Temperatura de funcionamiento: -20°C a 63°C.

Características eléctricas

- » Voltaje: 12Vdc - 24Vdc; 16Vac.
- » Consumo en reposo: 20mA (115mA max)
- » Capacidad de los relés: 2A.



Modelo
TECLADOEXF

Accessories

Power supply

Application

- » Electric power supply for all kinds of electromechanical, electromagnetic locks and direct current electric strikes.

Features

- » Input installation: 220 Vac/50 Hz.
- » FATEL 12V: 12Vdc/4,5 A:
- » Size: 122 x 60 x 35mm.
- » Connector wire equipped with earth connection.
- » Including support for installation.



Product code	Description
FATEL 12V	Power supply

Transformer

Application

- » Electric power supply for electric strikes and low consumption electromechanical locks.

Features:

- » Input installation 220Vac/50 Hz.
- » Output voltage 12Vac/0,5A.
- » Sizes: 79 x 44 x 32mm.
- » Internal fuse.
- » Weight: 0,325 Kg.



Product code	Description
TRFCERBIT	Transformer 12Vac



ASSA ABLOY

Talleres de Escoriaza, S.A.U.
Barrio Ventas, 35 • E-20305 Irun • SPAIN
Tel.: +34 943 669 100 • Fax: +34 943 622 189
www.tesa.es

ASSA ABLOY is the global leader in door opening solutions,
dedicated to satisfying end-user needs for security, safety and convenience.